



PROFILE ISTNIEJĄCEJ STOLARKI OKIENNEJ

- SZCZEGÓŁY

skala 1:2

Profile do odwr

Gboko stolarki

Szerc

f

g

b

c

d

e

f

g

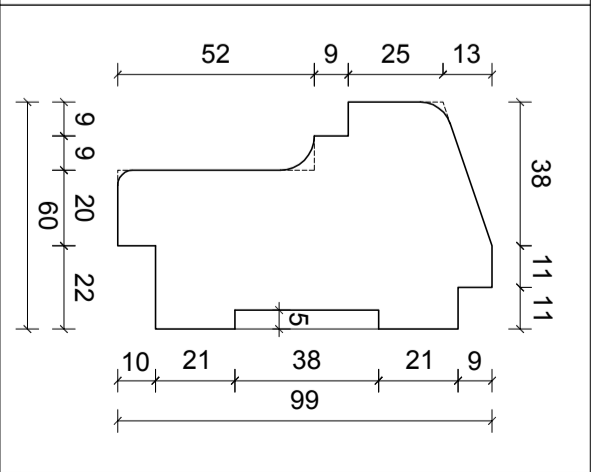
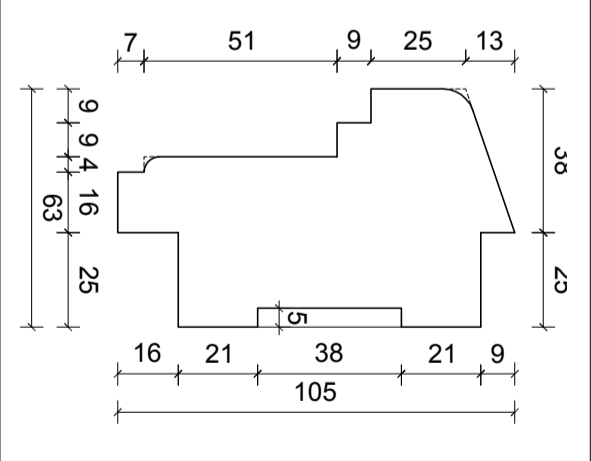
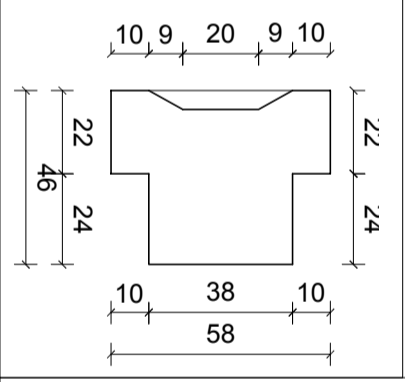
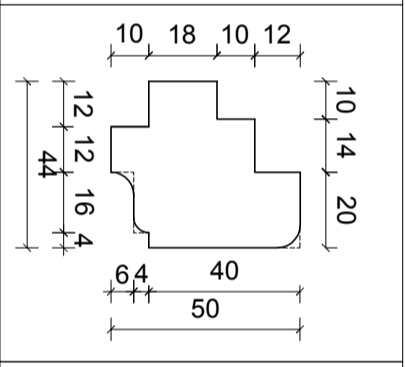
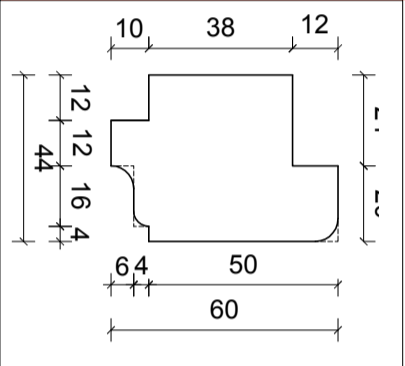
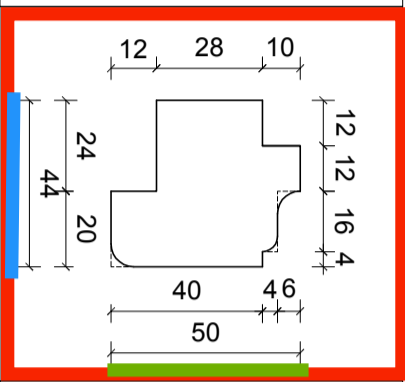
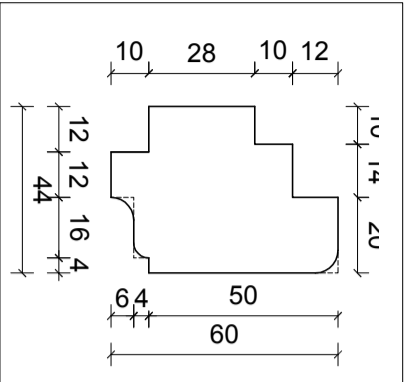

h

i

j

k

l

m

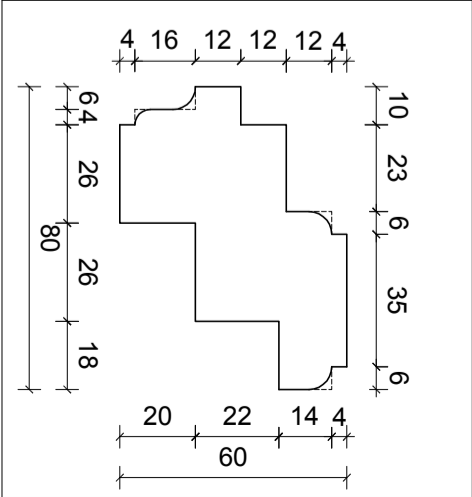
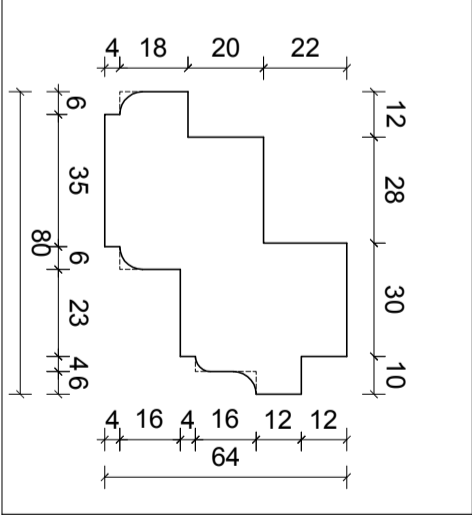
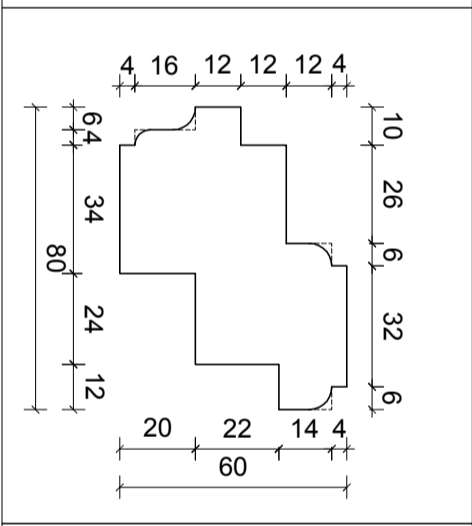
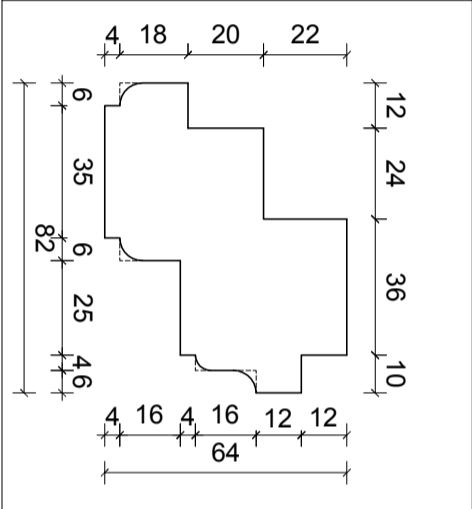
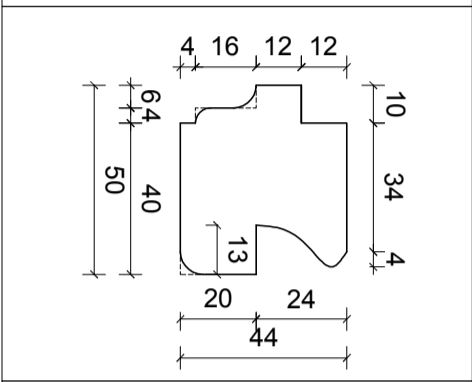
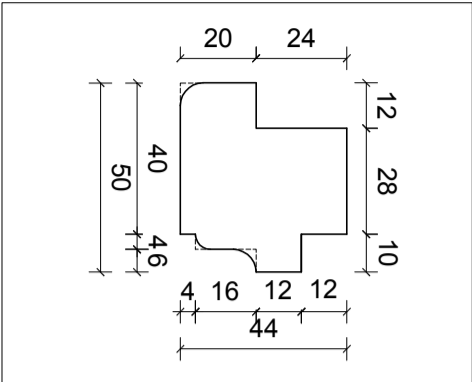

n

o

p

q

r

s

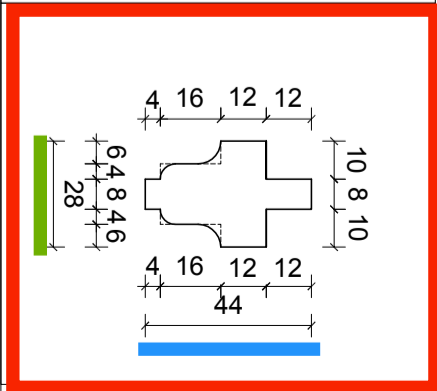
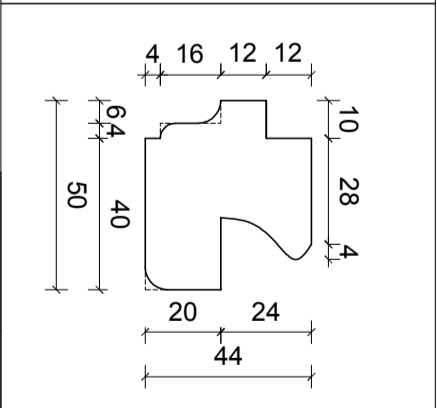
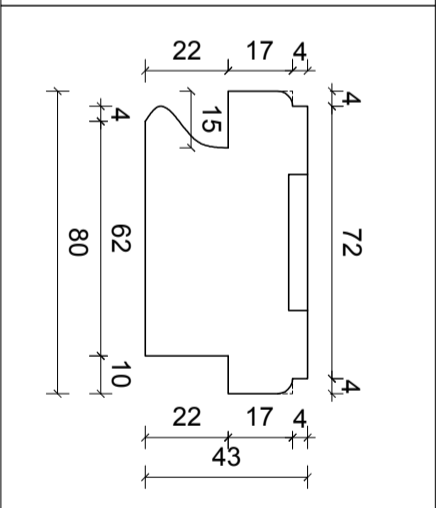
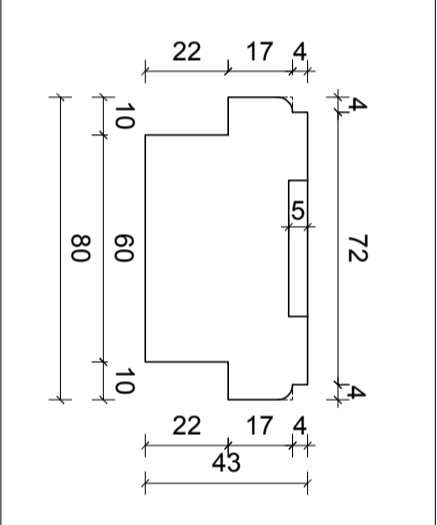
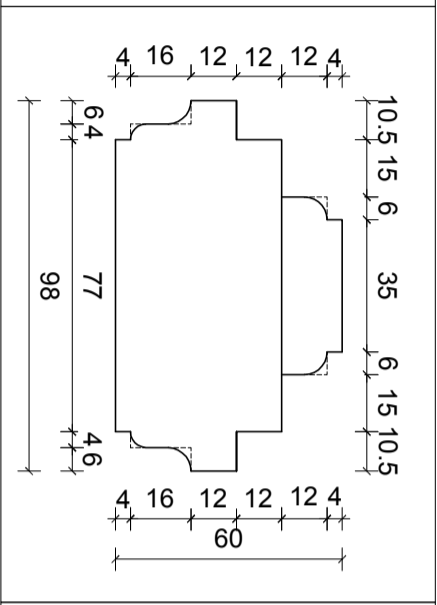
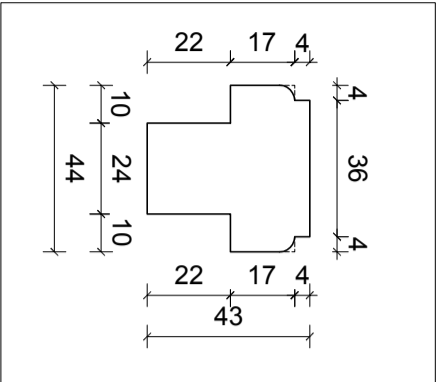

Uwaga!

Okno rekonstruować na wzór oryginału z zachowaniem wszystkich elementów, wymiarów, kształtów. Zastosować oryginalne kramki, zawiasy i okucia z okna pierwotnego. Wszystkie wymiary zwerfikować na budowie.

Obiekt:	Teatr im. Adama Mickiewicza w Cieszyńie
Skala 1:2	Plac Teatralny 1, 43-400 Cieszyń
Rys. nr 26	Temat: Program konserwacji i odtworzenia stolarki
Data: XII. 2017 r.	Treść: Profile stolarki okiennej - szczegóły
	Inwentaryzacja rysunkowo pomiarowa
	Opracował: Maria Osiełczak